

VPN (NordVPN)

Home Screen

On NordVPN's home screen, you can access the "VPN," "Threat Protection," "File share," and more. To get started, it is recommended that you click on "Quick Connect," as highlighted below in red. Once connected, the "Not connected" in red will change to say "Connected" in Green. You will also have the option, if you click the small "down arrow," to "Pause for 5 minutes" all the way to "Pause for 1 hour." You can also choose to "Reconnect" and "Disconnect" from there as well.

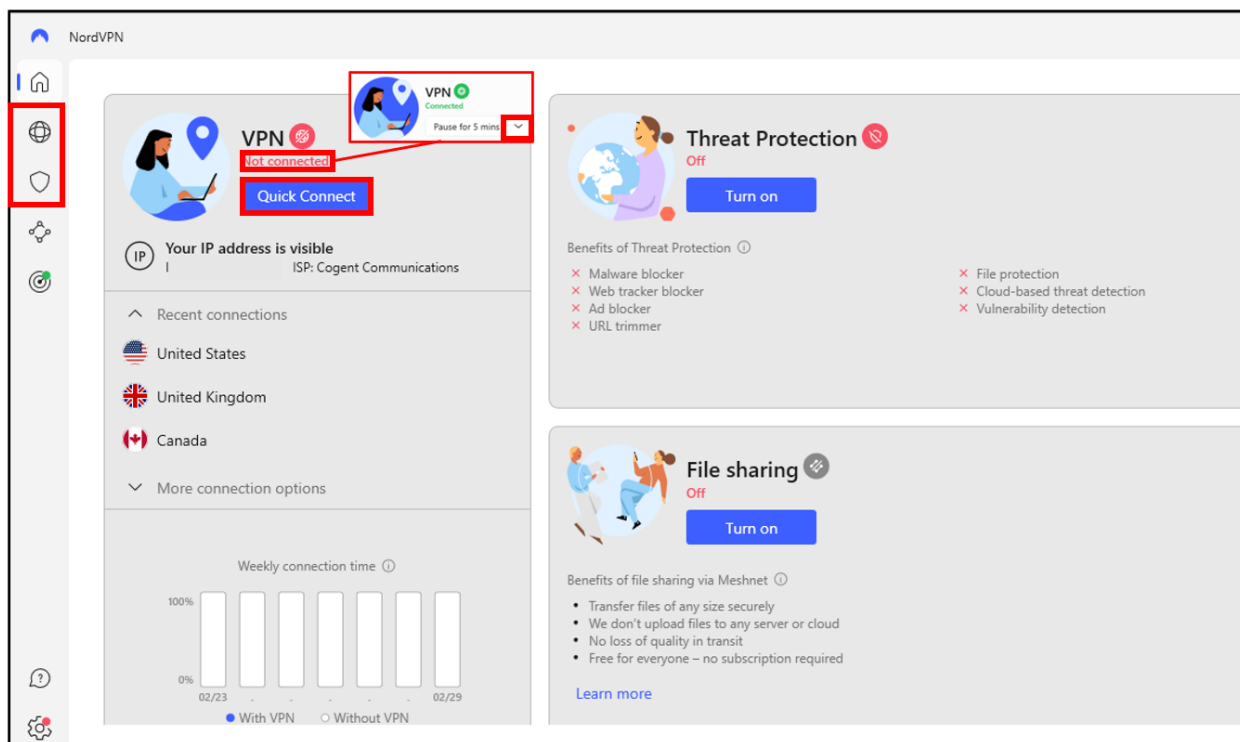

Home Screen/VPN

If you click on the "Globe" symbol on the bar to the left in the home screen, it will take you to a screen that shows the geographic location of where your VPN is routing to. You can also choose where you want your VPN to be through this map by clicking on the dots.

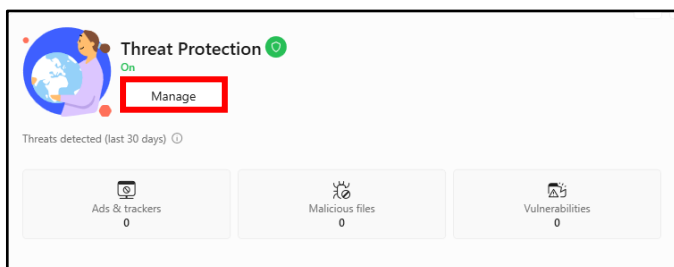
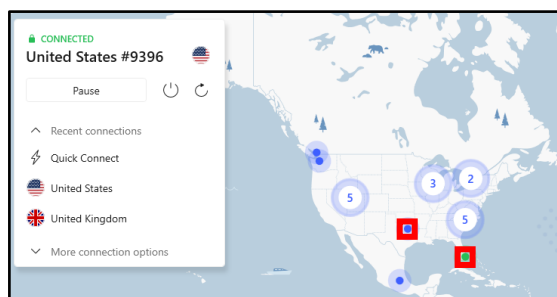

Home Screen/Threat Protection

If you click "Turn on" in "Threat Protection," the screen to the left will appear. From here you can click either "Manage" or the "Shield" symbol below the "Globe" symbol to manage your settings. Those settings will be shown on the next page.

VPN (NordVPN)

Threat Protection

Below is the "Threat Protection" hub. Here you can go through you "Web protection," "File protection," and "Vulnerability detection." Starting with "Web protection," you can go through the settings and choose what you would like turned on or off. If you just click "Turn on," below shows the features that are automatically enabled. Notice how "DNS filtering" is not auto on. Next is "File protection," which will scan each file you download for malware. You can also enable "Cloud-based threat detection" to have it upload the file to the cloud for an advanced scan. Last is "Vulnerability detection," which will notify you if any apps are vulnerable. If any are detected, they will be listed below.

Threat Protection

The screenshot shows three cards for Threat Protection:

- Web protection**: Protected. Includes a "Pause for 5 mins" button and a description: "Real-time protection against malware, trackers, and ads." A link "View activity and customize" is at the bottom.
- File protection**: Some features are off. Includes a "Pause for 5 mins" button and a description: "Prevention against malicious downloads." A link "View activity and customize" is at the bottom.
- Vulnerability detection**: Protected. Includes a "Turn off" button and a description: "Alerts about vulnerable apps detected on your computer." A link "View activity" is at the bottom.

Threat Protection > Web protection

Enjoy cleaner, safer, and more private internet. Threat Protection blocks cyber threats in real time as you browse the web.

The settings page lists several features with toggle switches:

- Web protection: On
- Malware blocker: On
- Ad blocker: On
- Web tracker blocker: On
- URL trimmer: On
- DNS filtering: Off

At the bottom, there are links for "Web protection activity" and "Excluded domains".

Threat Protection > File protection

Threat Protection scans each file you download, checking for malware. It deletes malicious files immediately and notifies you about it.

The settings page shows:

- File protection: On
- Cloud-based threat detection: Off

An information icon and text state: "Threat Protection activity will show up here."

Threat Protection > Vulnerability detection

Get notified about vulnerable apps we detect on your computer. We check our database of known app vulnerabilities multiple times a day.

The settings page shows:

- Vulnerability detection: On
- Last check: Never
- Check now button
- No vulnerabilities detected: If we detect any vulnerable apps with the next check, they will be listed here.

A laptop icon is visible in the bottom right corner.

VPN (NordVPN)

Meshnet

Moving on, highlighted below is “Meshnet.” This allows you to “Share files,” “Route traffic,” and “Link devices.” If you choose to link your devices, it will be shown below underneath “Personal devices” or “External devices.”

Meshnet

Meshnet
Connect this device to your virtual device network. On

Share files
Transfer files between linked devices securely and privately.

Route traffic
Access the internet under another device's IP address.

Link devices
Manage your invitations and link new devices.

Personal devices | External devices

This device ...

Link your other devices
Turn on Meshnet for your other devices with this NordVPN account, and they will link automatically.
[Learn more: Linking devices in Meshnet](#)

Dark Web Monitor

Next is “Dark Web Monitor,” which you can get to by click the symbol highlighted below. If you have this enabled, NordVPN will search leaked data linked to your email that you’ve registered with Nord. Any leaks will be posted below under the “Leaks” section.

Dark Web Monitor

Get alerts if your sensitive data is publicly exposed online. Dark Web Monitor searches for leaked data linked to your email address: passwords, contacts, or any other personal details.

Dark Web Monitor On

Build healthy password habits to keep your data safe
Try NordPass Premium to create strong passwords. Free for 30 days. No credit card required. [Try NordPass free](#)

Leaks | Cleared

Your info is safe
We've searched the dark web - your email address isn't there!

VPN (NordVPN)

Settings

At the bottom, on the home page, is the “Settings” tab. Here you can go through your “General,” “Connection,” “Kill Switch,” “Split tunneling,” and “Profile” settings. Be sure that if your version needs an update, to click the “Update” button as highlighted below. You can go through all these at your leisure, but “General” and “Kill Switch” are both that you should highly consider reviewing.

Settings

NordVPN 7.19.1.0

A new version of NordVPN is available!

Update

General

Choose your app preferences.

Connection

Manage your VPN connection.

Kill Switch

Prevent apps or your entire device from making unprotected connections.

Split tunneling

Choose which apps need VPN protection and which you can trust to access the internet directly.

Profile

Manage your account and subscription.

Settings (General)

Starting with “General” settings, it is recommended that you have “Launch the app at Windows startup” turned on, that way you will always be connected to the VPN and won't have to remember to do so.

Settings > General



Launch the app at Windows startup

Auto-start the NordVPN app every time you turn on your PC.

On



Launch the app minimized to system tray

Start NordVPN without opening the app window.

Off



Show VPN connection status notifications

Be notified when connecting and disconnecting from a VPN server.

On



Show the Meshnet file sharing option in the Windows context menu

Right-click on a file and select 'Send with NordVPN Meshnet' to start the transfer.

On

Settings (Kill Switch)

The “Kill Switch” prevents apps or devices from making unprotected connection. You can turn it on to disable the internet if your VPN connection drops.

Settings > Kill Switch

Prevent apps or your device from making unprotected connections. Kill Switch secures your data from accidental exposure by quitting selected apps or disabling the internet until VPN connection is restored.



Internet Kill Switch

Off



Disable internet access when a VPN connection drops unexpectedly



Disable internet access when you disconnect from VPN manually or the connection drops unexpectedly



App Kill Switch

Quit selected apps when not connected to VPN.

Off

Selected apps

Kill Switch applies to the apps added to the list.

Add apps